

North-South Corridor Darlington Upgrade Project

Major changes to traffic arrangements Ayliffes Road, St Marys February 2018



The Darlington Upgrade Project is being constructed in stages to ensure that traffic continues to flow efficiently through this important section of the North-South Corridor.

Late last year, traffic on Main South Road between the Southern Expressway and Ayliffes Road was switched onto the newly constructed Main South Road surface roads. This has enabled construction of the lowered motorway and new bridges at Flinders Drive, Sturt Road and Mimosa Terrace/Sutton Road to commence.

Traffic on Ayliffes Road now needs to be switched to the edges of the roadway in order to allow for the construction of the new Ayliffes Road bridge.

The Ayliffes Road traffic switch will occur between South Road and Norman Street, St Marys, and will come into effect on the weekend of 2-4 February 2018.

Traffic arrangements

- In order to maintain traffic capacity on Ayliffes Road whilst accommodating the work zone, a reversible lane will be in operation on Ayliffes Road during peak periods.
- This will enable three lanes of traffic to operate for eastbound (city bound) traffic during the morning peak (6am - 10am).
- It will also enable three lanes of traffic to operate for westbound (outbound) traffic during the afternoon peak (2pm – 8pm).

Traffic arrangements

- The reversible lane will be changed each morning and afternoon to cater for the required direction of traffic.
- At all other times, two lanes of traffic will operate in each direction on Ayliffes Road.
- Motorists will be required to closely observe on-site signage and changed speed limits.
- Ayliffes Road will remain open at all times.
- All existing turning movements will remain available at the Ayliffes Road, South Road and Shepherds Hill Road intersection.

Local access

- Due to the work zone that will be created in the centre of Ayliffes Road for construction of the bridge, right turns on the section of Ayliffes Road between South Road and Norman Street, St Marys, will not be available.
- Eastbound vehicles wishing to access the unit complex at 2 Ayliffes Road will be required to undertake a u-turn at a new u-turn bay on Ayliffes Road opposite Stanlake Avenue.
- Westbound vehicles wishing to access businesses on the northern side of Ayliffes Road will need to travel to the Sturt Road intersection, undertake a u-turn and then travel along Main South Road and onto Ayliffes Road.

Please refer to the map overleaf for further information.

These traffic arrangements will be in place until early 2019.



Australian Government

BUILDING OUR FUTURE



Government of South Australia

Department of Planning,
Transport and Infrastructure

Ayliffes Road traffic switch 2-4 February 2018

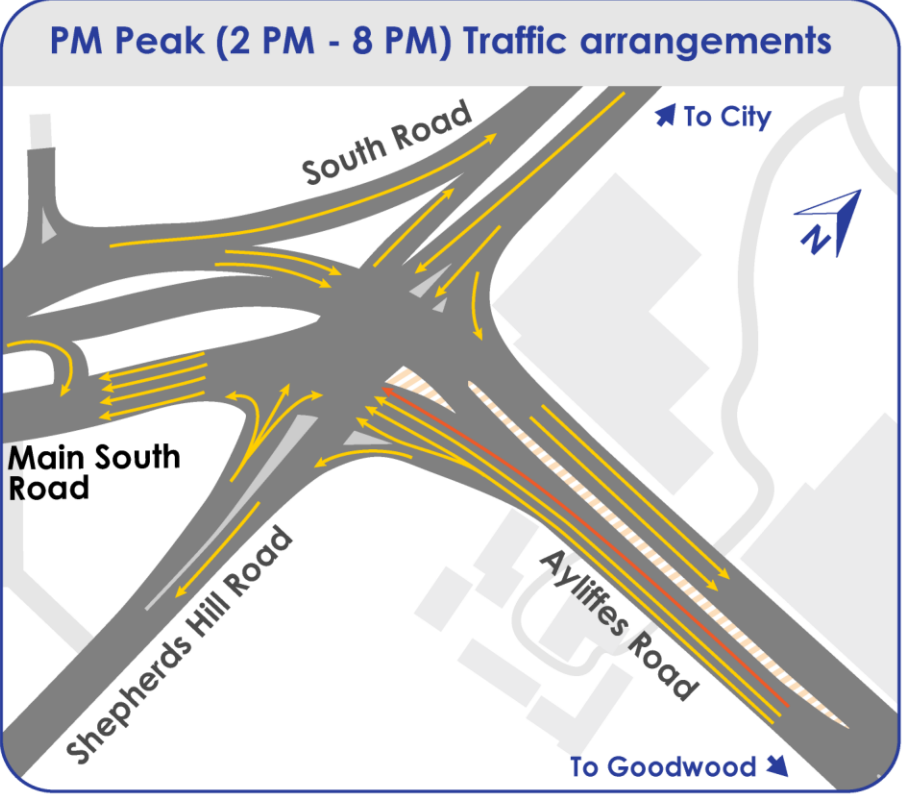
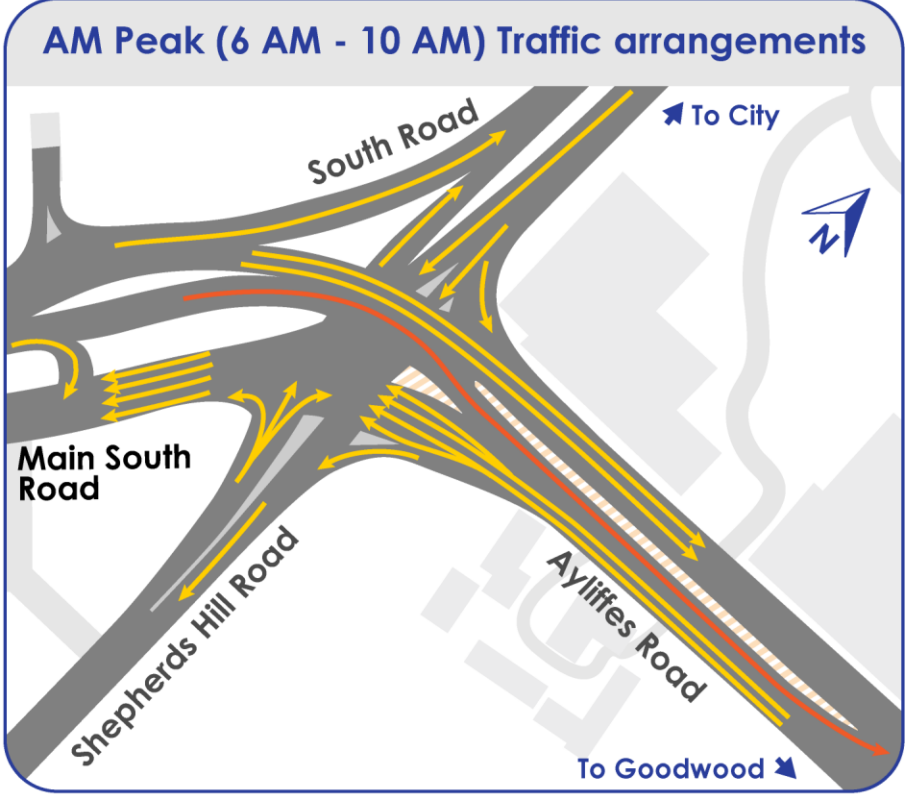
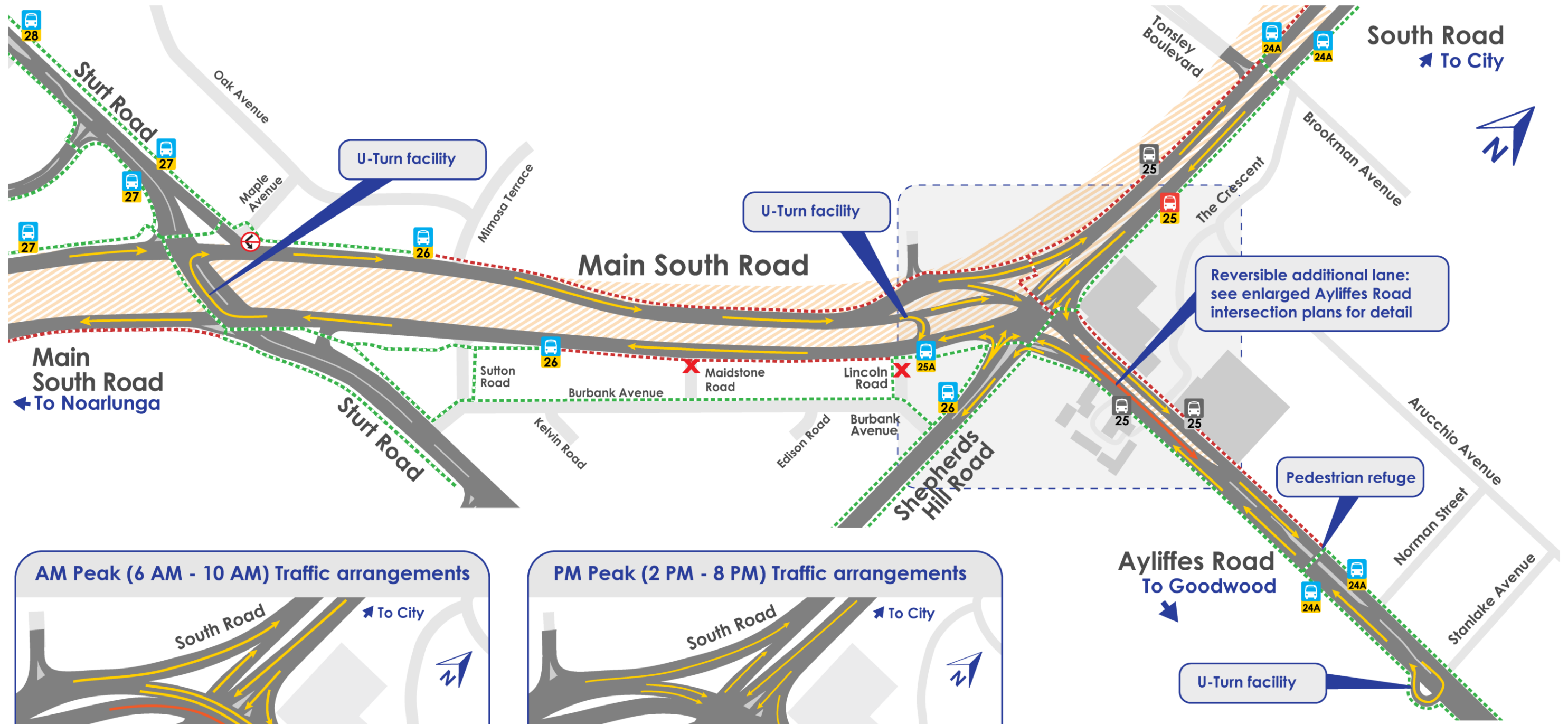

Legend

- Traffic flow
- U-turn facility
- Reversible lane
- Work Zone
- Road closed
- Pedestrian access
- Pedestrian access closed

Bus Services

- Bus stop no change
- Bus stop permanently closed
- Bus stop temporarily closed



Artists impression of the Ayliffes Road bridge

Pedestrians and cyclists

Pedestrian access on the western side of South Road from Tonsley Boulevard through to Mimosa Terrace will be permanently closed from 8pm on Friday 2 February 2018.

Bus Patrons

Bus stop 25 (northbound) on South Road, St Marys, will be permanently closed from 8pm on Friday 2 February 2018.

Patrons will be required to use bus stop 24A (northbound) on South Road.

Drive with care

From 8pm on Friday 2 February 2018, a number of activities will take place for the traffic switch, including:

- Altering traffic signal sequencing
- Asphaltting
- Line-marking
- Relocation of traffic barriers where required.

Please plan ahead, allow additional travel time, take extra care when workers are on site and observe speed and lane restrictions.

Traffic controllers will be in place and signage will alert motorists to the changed traffic conditions.

For more information

Call: 1300 759 334

Email: enquiries@gatewaysouth.com.au

Visit: infrastructure.sa.gov.au/darlington

Drop in to the project site office:
On the corner of Laffer Drive and Sturt Road, Bedford Park

The project supports equitable access to information. Translation of project information will be provided on request.

For real time delay information, please visit: www.addinsight.com.au and download the app.



Australian Government

BUILDING OUR FUTURE



Government of South Australia

Department of Planning,
Transport and Infrastructure